

newhomes



IN PLAY

COLLINGWOOD DEVELOPMENT OFFERS
FOUR-SEASON FUN BY LISA VAN DE VEN

Collingwood is both the location and the design inspiration for this home: the 1,711-square-foot Nicklaus model at Blue Fairway. Designer Michelle Pasquale brings the outdoors in, with a rough-hewn fireplace and wood accents, while nautical-themed linens in the master bedroom evoke images of the marinas nearby. Even the blue and green accent colours are inspired by the local landscape. The result is a chalet-vibe aesthetic with a certain local flare. “I wanted to illustrate the project’s name, playfully, but at the same time represent the four-seasons lifestyle the Collingwood area has to offer,” says the interior designer with developer MacPherson Builders. Homes at Blue Fairway range from 1,216 to 1,473 square feet, and from \$299,400 to \$347,400. The sales office is located at 5 Cranberry Trail E., Collingwood, and open Wednesday to Sunday from noon to 5 p.m. Call 705-293-2201, or visit bluefairway.ca.

1 Maple cabinets, stained dark, “create contrast with the walls, while complementing the flooring,” Pasquale says, while the Shaker-style doors and a glass-front corner cabinet add detail. Mouldings along the top give the cabinets a more finished look — perfect for residents looking down from the loft above.

3 The bronze, wood and leather light fixture adds “texture, depth and dimension” to the chalet-style great room, while the cultured-stone fireplace creates another rustic focal point. “I’ve used the fireplace as my starting point to bring the outside in,” Pasquale says.

2 “They allow us to get that natural stone look and feel, but with more consistency in colour and tone,” the designer says of the kitchen’s quartz countertops. The counters are complemented with a taupe-toned glass tile backsplash, featuring a mix of glossy and matte tiles for added texture.

4 “It creates that comfy feeling when you come in from enjoying the outdoors,” Pasquale says of this large-scale taupe leather sofa. She’s paired it with a smaller, more feminine chair featuring a floral pattern in blue and green. “The chair elevates the casual feeling,” the designer adds.

FOR SALE

Price range: Starting from the mid \$200,000s
Location: Yonge Street and Eglinton Avenue, Toronto

SET TO SOAR

Featuring architecture by Giannone Petricone Associates, and interiors by Mike Niven Interior Design, The Eglinton is a midtown Toronto condominium project. It will have 445 units.
Builder/developer Menkes Developments
What’s new Demolition is now complete at the site, with construction about to begin.
Building 34 storeys
Suites Studio, one-bedroom, one-bedroom-plus-study, one-bedroom-plus-den and two-bedroom layouts
Size 359 to 871 square feet
Occupancy Fall 2018
Features Laminate and ceramic tile flooring, quartz kitchen countertops, ceramic or porcelain tile backsplashes,



and Energy Star appliances
Amenities A lounge, a party room, a dining room, a billiards/games room, a gym, a terrace, two guest suites and 24-hour concierge service
Standouts The site is a short walk to the Eglinton subway station.
Sales office Located at 770 Bay St., Toronto. Open Monday to Thursday from noon to 6 p.m. and weekends from noon to 5 p.m. Call 416-591-7700 or visit menkes.com.
L.V., National Post

Price range: Starting from the high \$200,000s
Location: Martha Street and Lakeshore Road, Burlington

LAKE VIEWS

A lakefront Burlington project close to Spencer Smith Park and the Waterfront Trail, Nautique will feature 192 condominium units. The project was designed by RAW Design, and will feature interiors by Cecconi Simone.
Builder/developer Adi Development Group
What’s new The site’s sales office opens to the public this weekend (Feb. 6).
Building 26 storeys
Suites One-bedroom to two-bedroom-plus-den layouts are available.
Size Range from 452 to 1,316 square feet.
Occupancy Slated for November 2018.
Features Units will have floor-to-ceiling windows, integrated appliances, wide-plank



laminate flooring and ceiling heights of up to 11.5 feet.
Amenities The site will feature a fitness centre, an outdoor pool and a terrace with barbecue alcoves.
Standouts The building’s Sky Lounge will feature 360-degree views overlooking Lake Ontario and the city.
Sales office Located at 375 Brant St., Burlington. Open Monday to Thursday from 1 to 6 p.m., weekends from noon to 5 p.m., and Friday by appointment. Call 289-337-0766 or visit adidevelopments.com.
L.V., National Post

Price range: Starting from the \$300,000s
Location: Pearl Street and John Street, Toronto

IN THE THICK OF IT

Located in Toronto’s Entertainment District, The PJ is the second phase to the downtown Pinnacle on Adelaide project. It’s located close to TIFF Bell Lightbox, the Princess of Wales Theatre, Roy Thomson Hall and the Scotiabank Theatre Toronto, with shopping and restaurants situated throughout the area.
Builder/developer Pinnacle International
Building 48 storeys, with a six-storey podium
Suites Studio, one-bedroom, one-bedroom-plus-den and two-bedroom layouts
Size Range from over 400 to over 900 square feet.
Occupancy Scheduled for 2019

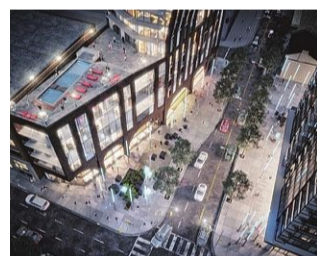

Features Units will have nine-foot ceilings, laminate flooring, stainless steel appliances, granite or quartz countertops, deep soaker tubs and rain showerheads.
Amenities The site will feature a party room, a dining room, a business centre, an outdoor pool and hot tub, barbecues and a fitness centre.
Standouts The project is close to the King streetcar service, with the St. Andrew subway station close by.
Sales office To register, visit pjcondos.ca.
L.V., National Post

MORTGAGE RATES 03.02.16

RATES ARE SUBJECT TO CHANGE. SELECTION OF FINANCIAL INSTITUTIONS MAY VARY WEEKLY. FIGURES SUPPLIED BY FISCAL AGENTS

	Variable rate	6months	1yr	2yr	3yr	4yr	5yr		Variable rate	6months	1yr	2yr	3yr	4yr	5yr
BANK								TRUST LOANS							
ATB Financial	2.60	4.00 - 4.00op	2.94 - 4.00op	2.64 - 4.00op	2.64	2.74	2.94	Community Trust	n/a	6.50	3.14	3.25	3.95	4.39	4.64
Alterna Svgs/Alterna Bk	2.70	4.00 - 6.30op	2.85 - 6.30op	2.79	2.59	2.84	2.88	Concentra Financial	n/a	5.00 - 6.70op	2.89 - 6.30op	2.59	3.39	3.89	4.64
Bank of Montreal	2.70	4.00 - 6.75op	2.89 - 6.75op	2.99	3.39	3.89	2.89	Effort Trust	n/a	4.45 - 6.30op	3.35 - 6.30op	3.50	3.70	4.30	4.35
Bank of Nova Scotia	2.70	4.55 - 6.45op	3.29 - 6.50op	3.09	3.39	3.89	4.49	Home Trust Company	2.35	3.95	2.69	2.24	2.39	2.59	2.74
Canadian Western Bank	-	4.00 - 6.45op	3.14 - 6.30op	3.04	3.65	4.20	4.74	Investors Group Trust	n/a	4.20 - 6.50op	3.14 - 6.30op	3.09	3.39	3.89	2.84
CFF Bank	-	-	2.69	2.24	2.39	2.59	2.74	MTCC	2.70	4.55 - 6.45op	3.29 - 6.50op	3.09	3.39	3.89	4.49
CIBC	2.70	6.95op	2.84 - 6.35op	2.79	2.59	2.84	4.79	OTHER							
Equitable Bank	-	-	3.14	3.04	3.65	4.39	4.64	Comtech Credit Union	2.45	6.20 - 6.40op	2.84 - 6.30op	2.89	2.95	2.99	2.89
ICICI Bank Canada	2.75	-	3.15	3.65	3.64	3.69	3.69	DUCA Credit Union	2.50	-	3.09 - 5.75op	3.00	2.99	3.09	2.79
Manulife Bank	2.40	4.45	3.00 - 3.20op	2.94	2.84	2.79	2.89	First National Fin. LP	-	3.10	2.29	2.24	2.49	2.64	2.79
National Bank	n/a	4.40 - 6.70op	3.14 - 6.70op	3.04	3.39	2.84	3.04	Industrial Alliance/IAP	-	-	3.19	2.89	3.04	3.29	2.74
President’s Choice Finan	2.70	-	-	2.79	3.34	3.99	4.44	Luminus Financial	3.25	-	3.25 - 6.25op	3.20	3.65	4.00	4.50
Royal Bank	2.60	6.75op	3.14 - 6.75op	2.39	2.69	2.84	3.04	Meridian Credit Union	2.40	4.00	1.69 - 6.30op	3.09	3.55	4.19	2.59
TD Canada Trust	2.60	-	2.99 - 6.30op	2.29	3.39	2.74	2.94	PACE Savings & C.U.	-	5.00 - 6.70op	2.89 - 6.30op	2.59	3.39	3.89	4.64
Tangerine	2.70	-	3.19	3.24	3.49	3.69	3.79	Parama Credit Union	2.65	-	2.80 - 2.95op	2.85	2.95	3.05	3.15

*Also offer 7- to 10-year mortgages. op = open mortgage. n.a. = not available from company. ro=renewals only dashes (-) mean companies not quoting at present.